

Deep discharge of the battery may damage it or reduce its operating time. Non-compliance with the above recommendations is treated as damage caused by the user and is not covered by the manufacturer's warranty.

7. *CARRIAGE DESIGN, MAIN UNITS*

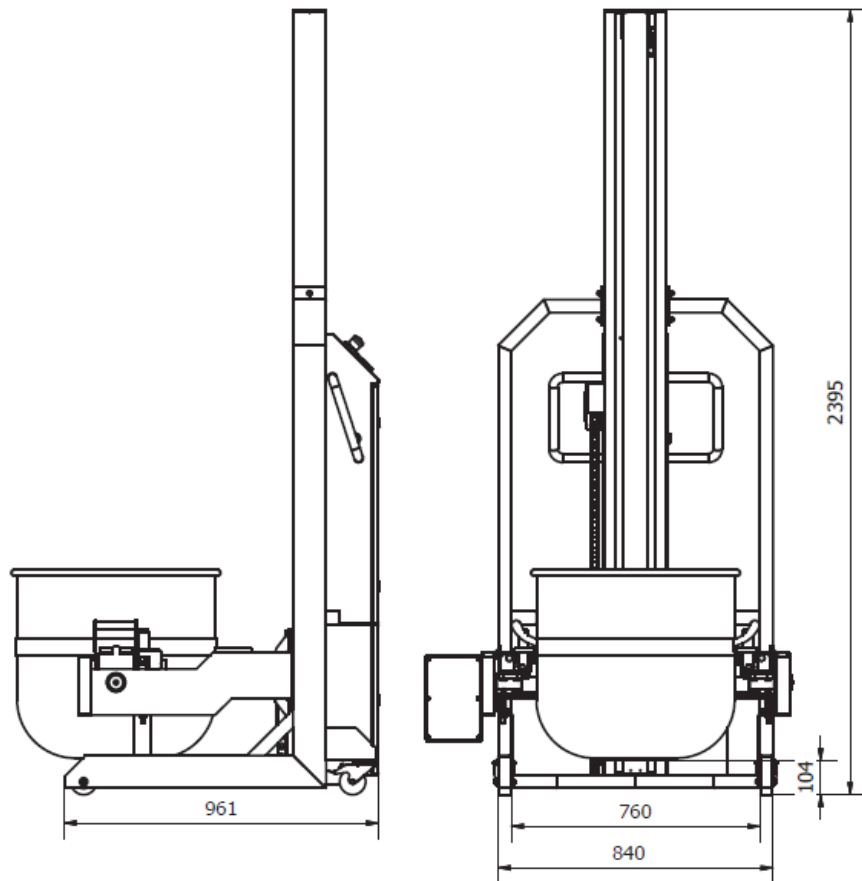

Lifter main measurements

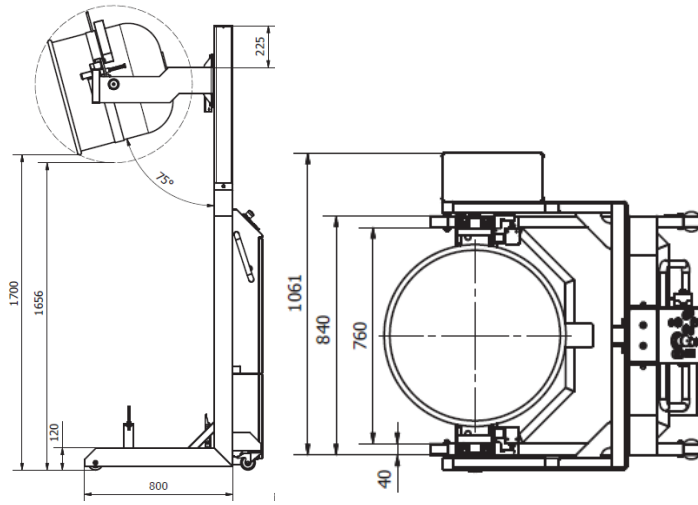

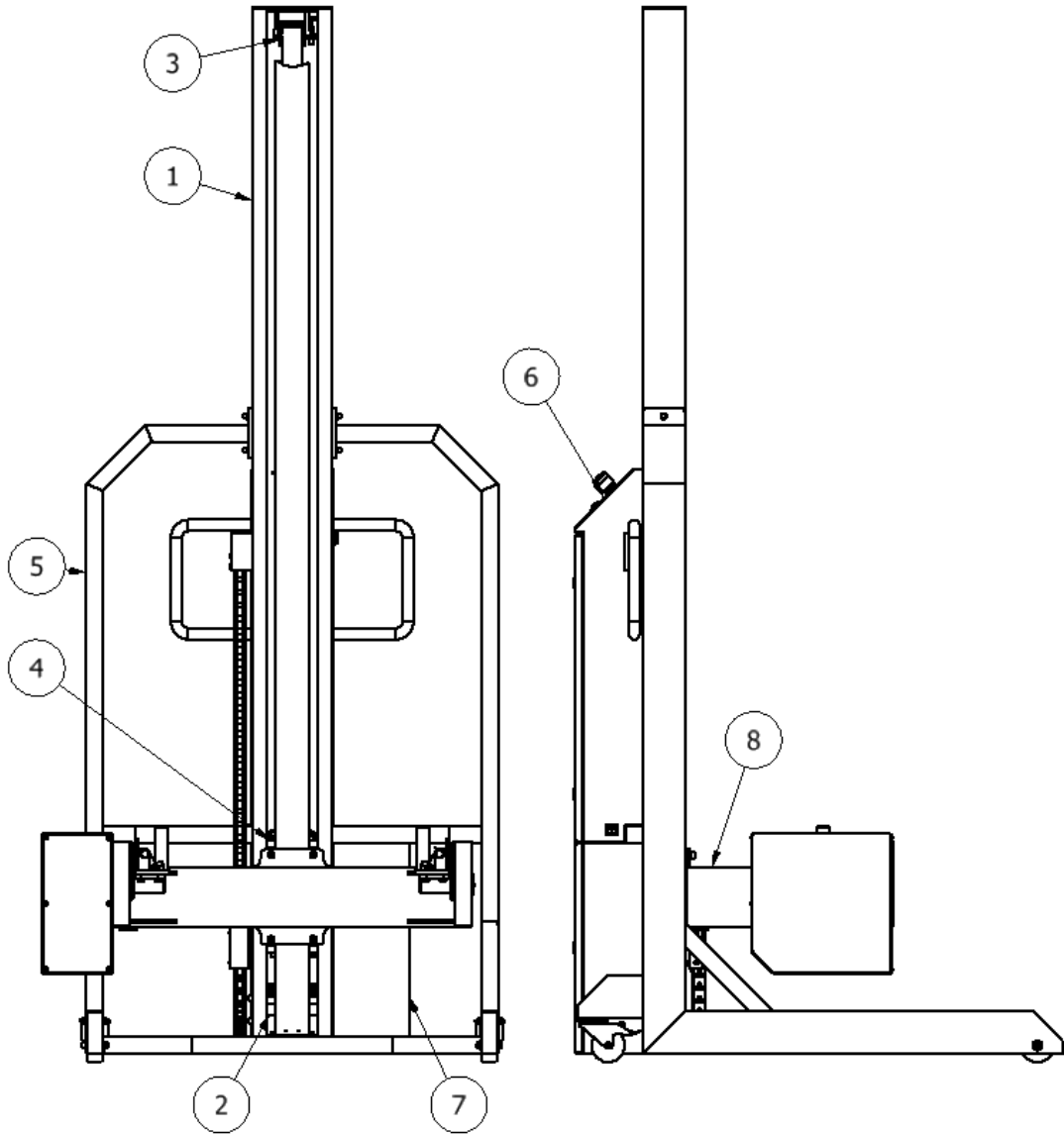

Main units:

- | | |
|------------------|------------------------|
| 1. Pole | 6. Control box |
| 2. Lifting drive | 7. Drive covers |
| 3. Top roller | 8. Bowl frame |
| 4. Carriage | 9. Battery compartment |
| 5. Frame | |

7.1. LIFTING DRIVE

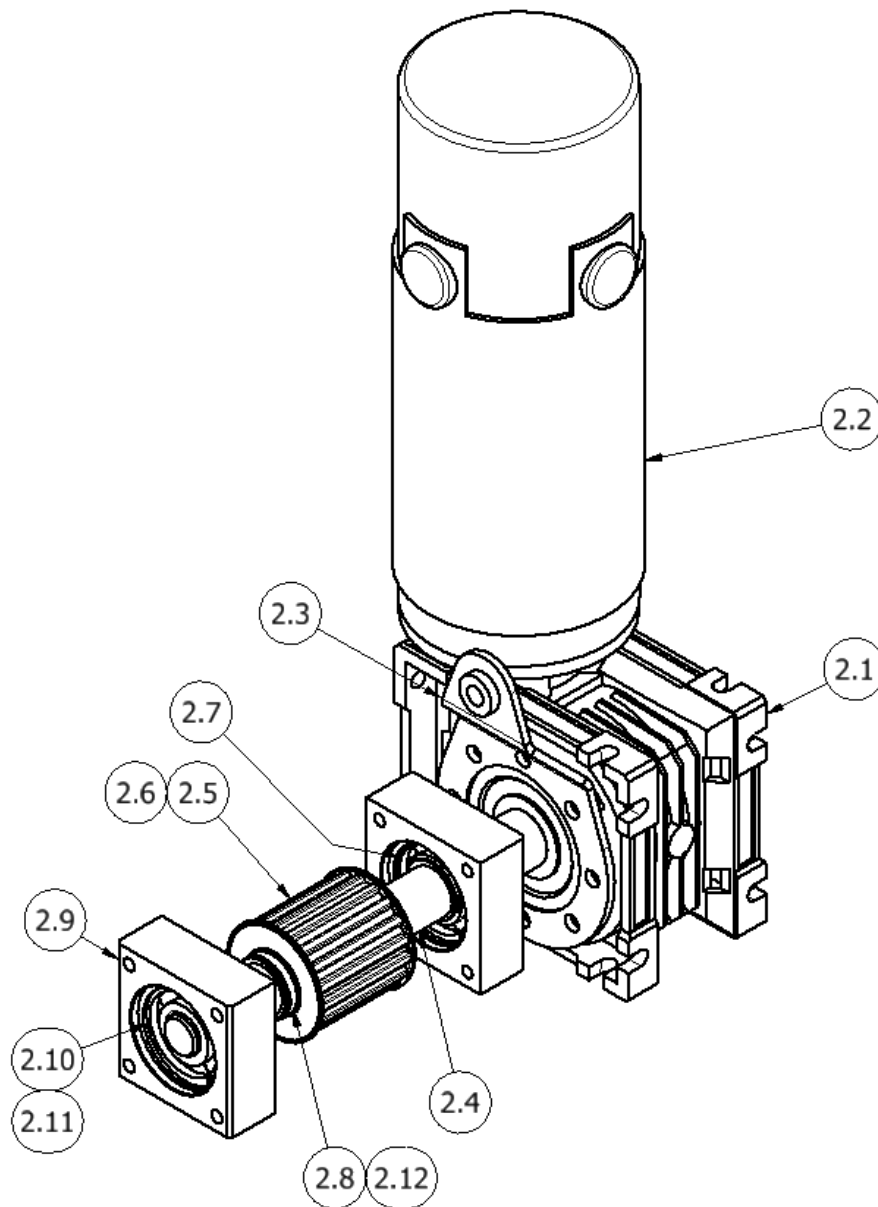

No.	Pcs/machine	Part name	Drawing or index no.
2.1	1	Screw reducer	050 i=100 IEC71 B14
2.2	1	Motor 24V	DC EC600.240 71B14 24VDC BR
2.3	1	Torque arm	HUB-2-02.01.00
2.4	1	Shaft reducer	HUB-2-02.02.00/a
2.5	1	Toothed pulley	HUB-2-02.03.00

2.6	2	Overrunning clutch	HFL2530
2.7	1	Pumping bearing	6205 ZZ
2.8	2	Roller bearing	WD-1-02.04.00
2.9	2	Bearing housing	HUB-2-02.06.00
2.10	1	Roller bearing	6304 ZZ
2.11	4	Stopper ring	W 52 DIN 471
2.12	3	Stopper ring	Z 25 DIN 471

7.2. TOP ROLLER

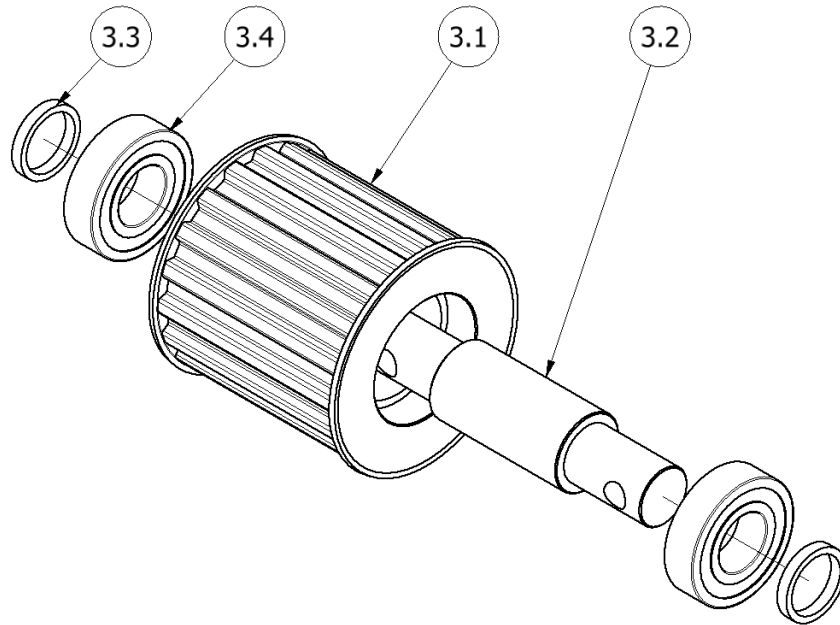

No.	Pcs/machine	Part name	Drawing or index no.
3.1	1	Retard roller	HUB-2-03.01.00/a
3.2	1	Retard roller axle	HUB-2-03.02.00/a
3.3	2	Spacer ring	HUB-2-03.03.00
3.4	2	Ball bearing	6002 RS

7.3. CARRIAGE

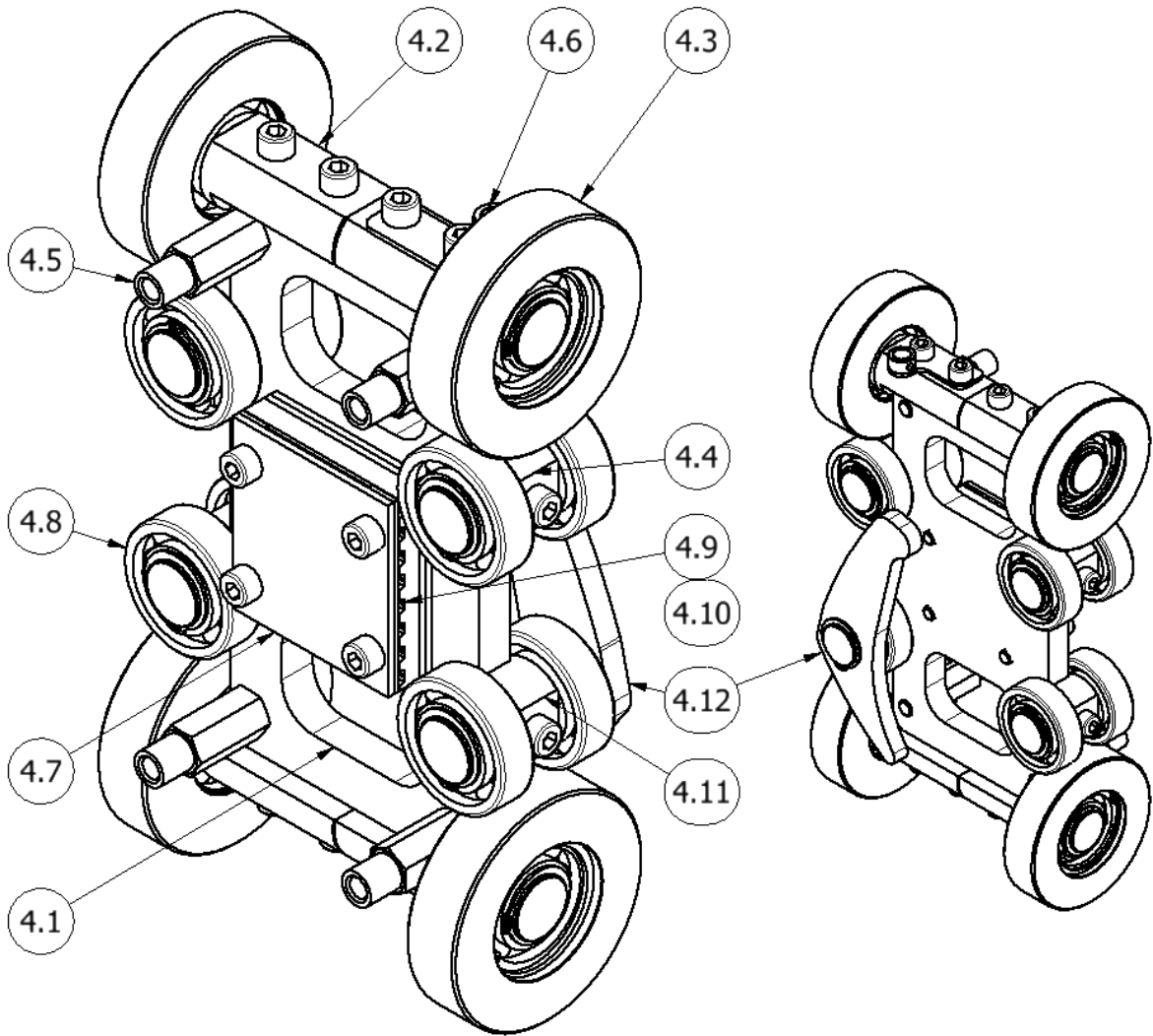

No.	Pcs/machine	Part name	Drawing or index no.
4.1	1	Main plate	HUB-3-HOB140-04.01.00
4.2	4	Bearing pivot	HUB-3-HOB140-04.02.00
4.3	4	Roller	HUB-2A-04.03.00
4.4	3	Bearing axle	HUB-3-HOB140-04.04.00
4.5	4	Special bolt	HUB-2A-04.05.00
4.6	1	Neodymium magnet	MW 10x8
4.7	3	Belt protection plate	HUB-2-04.07.00

4.8	12	Bearing	6205 ZZ
4.9	2	Clamping plate AT10 50	
4.10	1	Belt AT10, width 50 mm, open length 3690 mm	
4.11	1	Bearing and cam axle	HUB-3-HOB140-04.12.00
4.12	1	Cam	HUB-2A-04.11.00

7.4. BOWL FRAME

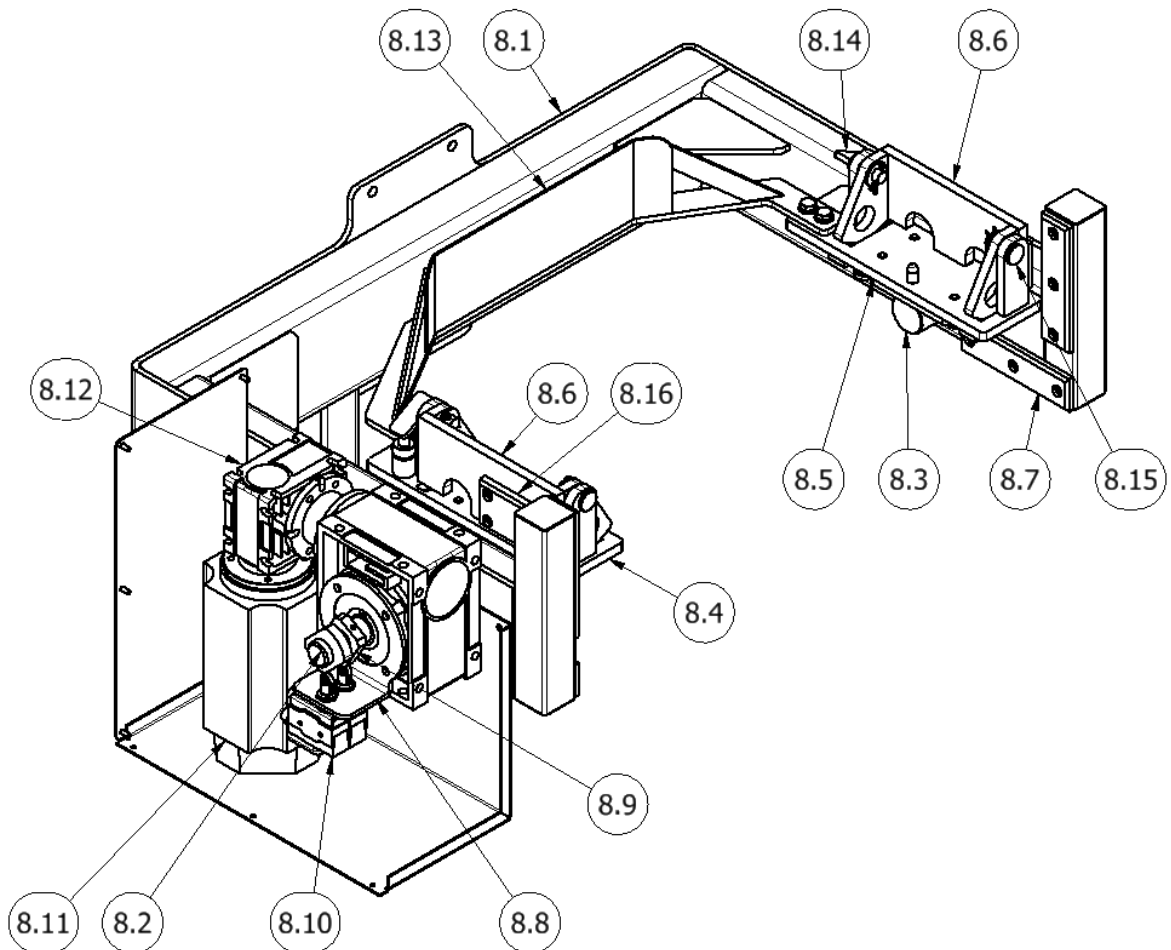

No.	Pcs/machine	Part name	Drawing or index no.
8.1	1	Frame	HUB-2CG-08.01.00

MADE IN ITALY

8.2	1	Long axle	WD-1-08.02.01
8.3	1	Short axle	WD-1-08.03.01
8.4	1	Left support	HUB-2CG-08.05.00
8.5	1	Right support	HUB-2CG -08.04.00
8.6	2	Bowl lock	HUB-2CG -08.06.00
8.7	4	Lining	HUB-3-HOB140-08.00.04
8.8	1	Limit sensor holder	WD-1-08.00.06
8.9	2	Cam	WD-1-08.02.03
8.10	1	Micro switch with roller	D5020
8.11	1	Motor 24V 190W QS7 IEC63 B14	
8.12	1	Double screw reducer	030+050 i=2000
8.13	1	Rest plate	HUB-2CG-08.07.00
8.14	2	Connector	HUB-2CG-08.09.00
8.15	2	Pin	WD-1-08.00.01
8.16	2	Lining	HUB-2C-08.00.05

7.5. LIST OF ELETRICAL PARTS

LP	pcs pro machine	Part name	Nr	Symbol on the diagram
1.	1	Magnetic sensor	SMC-10 S	KR1
2.	1	Motor 800W 24VDC	EC600.240 B12 24VDC	M1
3.		Motor 180W 24VDC	EC180.240 B12 24VDC	M2
4.	4	Button drive with automatic return	M22-D-X 216602	
5.	1	Button drive with automatic return	M22-D-G 216602	
6.	4	Button insert 22mm black	M22-XD-S-X7 218173	
7.	1	Button drive double green / red / START-STOP / with backlight automatically	M22-DDL-GR-GB1/GB0 216702	S2
8.	7	Fastening connector	M22-A	
9.	5	Protective membrane for buttons and lights	M22-T-D 216395	
10.	1	Protective membrane for double buttons	M22-T-DD 216396	
11.	1	Battery charge panel indicator	824.1.24.008 24VDC	Bauser
12.	2	VRLA battery 12V	FG 22703 lub odpowiednik	BAT.1 BAT.2
13.	3	contactor 3 pole 24VDC 38A DIN	BF38 00 D024	K1M, K2M, K3M
14.	2	contactor 3 pole 24VDC 12A DIN	BF12 01 D024	K4M, K5M
15.	1	Mechanical lock	BFX5000	
16.	1	Auxiliary side contact	BFX1211	
17.	2	Electromagnetic relay	HR502CD024	K1, K2, K3
18.	1	Charger	CBC 10	
19.	1	Glass fuse	4A	F2

20.	1	Overcurrent breaker	P1 MB C32	F1
21.	1	Safety button red	M22-PV	
22.	22	Nipple	24G-G4 czerwony	
23.	2	Nipple	24G-G4 czarny	
24.	1	Nipple	24G-G4 biały	
25.	6	CONTACT NO	M22-K10	S3,S4,S5,S6,S7
26.	2	CONTACT NC	M22-K01	S1, S2
27.	1	Socket	ZUG G/B	
28.	2	Rotary switch	D 5020	