

shield (11), removing the cover (3) and unlocking the locking pawl with your foot (MC/2E -30 only) or turning the hand wheel (31).

3.4 MACHINE PARTS NUMBERING

Drawing 1		
Item	Part	Description
1	Frame	Made of stainless steel.
2	Top cover	Covers the mixer drive.
3	Kneading trough cover	While the machine is in operation, the cover must lie on the kneading trough, and its key must be pushed into the end connector (10).
4	Kneading trough with oil shell	Made of stainless steel, used as a product heater and tank.
5	Pedal	When pressed with your foot, the pawl (7) releases the lock and allows the user to empty the trough using the handle (8).
6	Connector	Connects the pedal (5) with the pawl (7).
7	Pawl	Holds the handle (8) secured against accidental turning.
8	Handle	Connected with the kneading trough, allows the user to empty the trough.
9	Back shield	Prevents access to heaters.
10	End connector	Prevents machine operation when the key (being an integral part of the cover (3)) is not pushed properly into the body.
11	Front shield	The shield may be open only when the kneading trough is supported on the provided rest, and the user removes the cover from the kneading trough.
28	Top back shield	Prevents access to hot parts on the back of the kneading trough.
31	Hand wheel	Used for emptying the kneading trough.

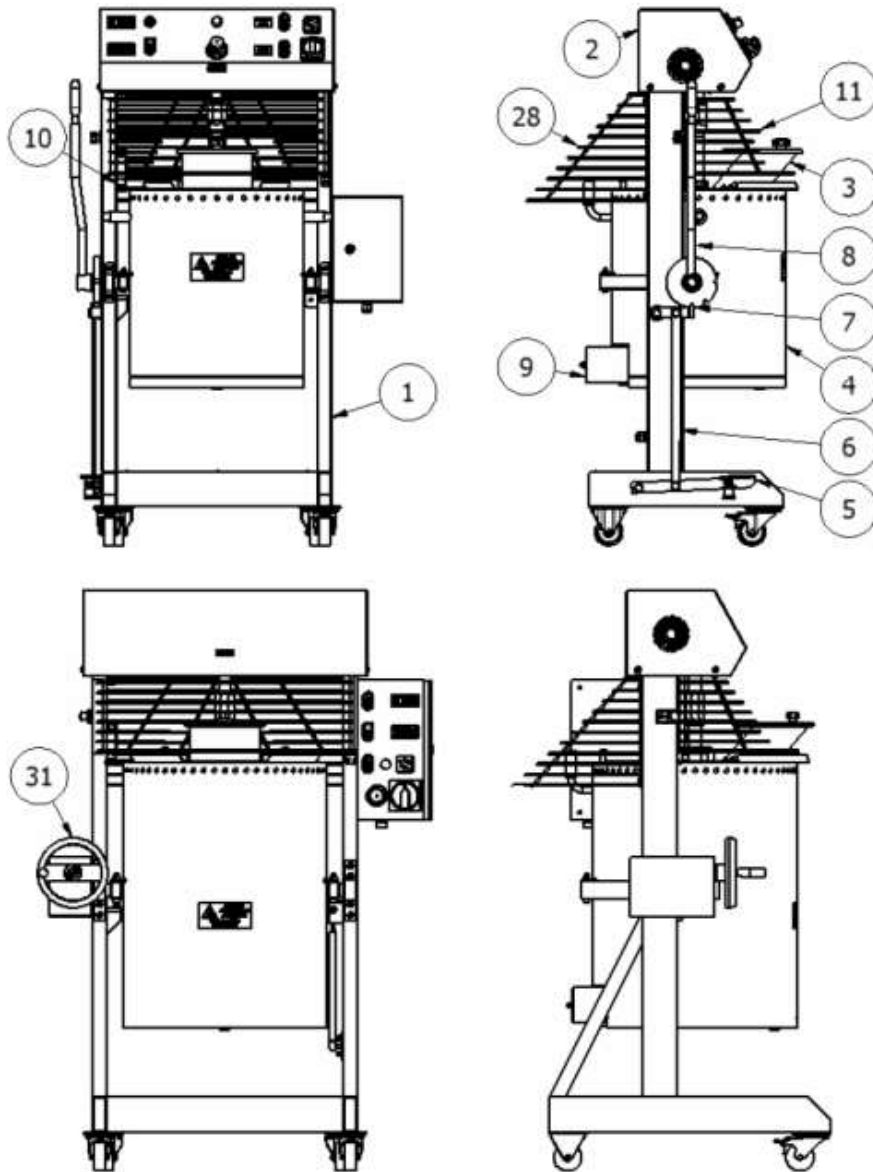

Figure 1. Machine parts numbering

Drawings 2, 3 and 4 – Design		
Item	Part	Description
1	Frame	
2	Top cover	
3	Kneading trough cover	While the machine is in operation, the cover must lie on the kneading trough, and its key must be pushed into the end connector.
3a	End connector key	

4	Kneading trough with oil shell	Made of stainless steel, used as a product heater and tank.
4a	Kneading trough sleeve	
10	End connector	Prevents machine operation when the key (being an integral part of the cover (3)) is not pushed properly into the body.
12	Mixer lock	Connects the drive shaft (13) with the mixer (14), enabling drive transmission.
13	Drive shaft	
14	Mixer	Used for mixing various ingredients. Made entirely of stainless steel.
14a	Slide-in pin of the mixer	Constitutes the bottom support of the mixer. Made of stainless steel.
14b	Bottom scraper of the mixer	
14c	Side scraper of the mixer	
14d	Middle side scraper	Present in MC60/2E – 1 scraper; MC80/2E 2 scrapers; MC120/2E – 3 scrapers.
14e	Top side scraper	
16	Electric cabinet	
17	Reducer	
18	Two-gear motor	
19	Time relay	Used for setting heating time in the kneading trough.
20	Emergency switch	Stops the machine in emergency.
21	Mixer connector (Start/Stop)	Starting or stopping mixer operation.
22	Heaters connector	For starting or switching off kneading trough heaters. When the heaters are in operation this is signalled by the connector lighting in red.
23	Signal light	Indicates that shields are closed.
24	Rotational speed selector	Used for starting and stopping the mixer motor. When switched to position 1, rotational speed will be fast; and when switched to position 2, rotational speed will be slow. When the switch is in 0 position, the mixer is not moving.
25	Emergency and main cut-out	The switch may be set in two positions: 0 – the machine is stopped; 1 – power is supplied.
26	Starting switch (I, 0, II)	Used for starting the machine: I – operation with heating time measured 0 – no heating
27	Temperature controller	Used for setting desired mixing temperature. Attention: THE DEFAULT MAXIMUM TEMPERATURE SETTING IS 150 °C. THE MANUFACTURER DOES NOT ALLOW INCREASING THIS TEMPERATURE. Applying higher temperatures creates a genuine fire hazard.

31	Hand wheel	Used for tilting the kneading trough in order to empty it.
32	Catch	Locks the front shield (11).
33	Rotation reducer	Used for tilting the kneading trough in order to pour out the contents

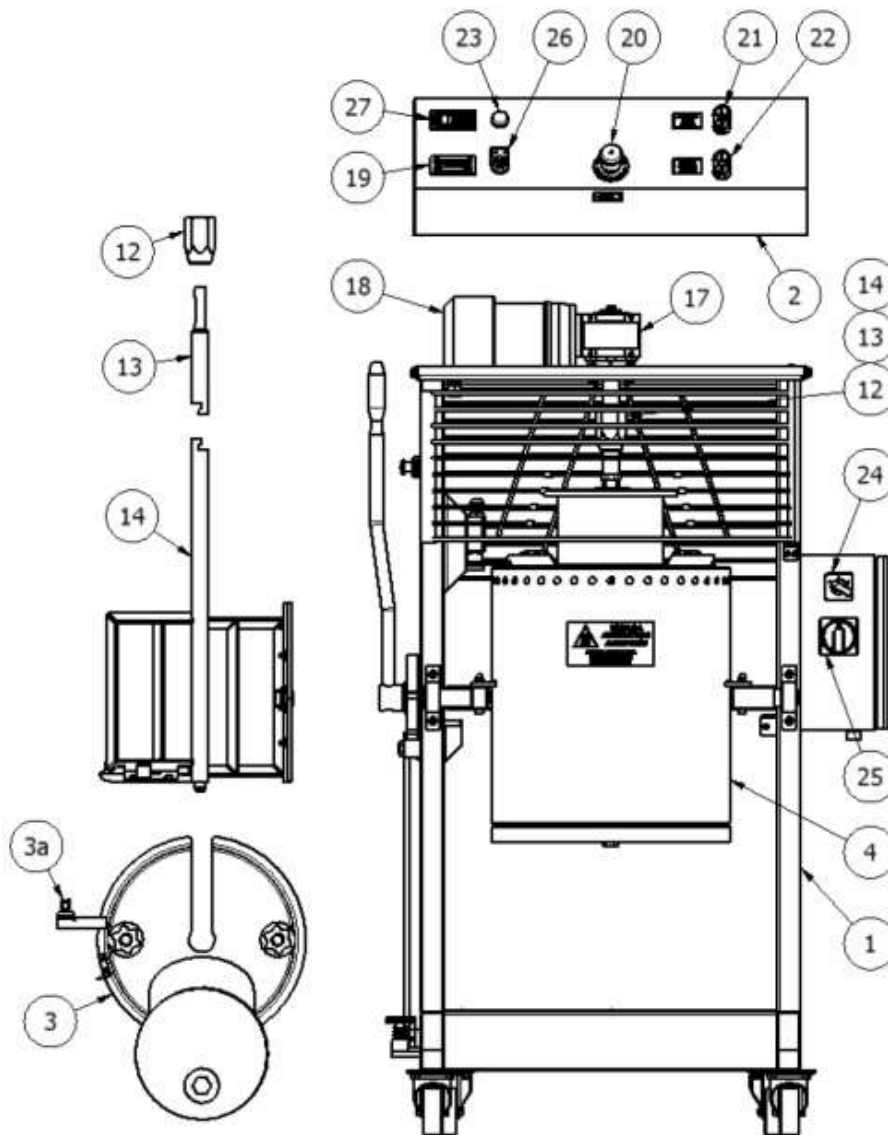

Figure 2. MC30/2E design

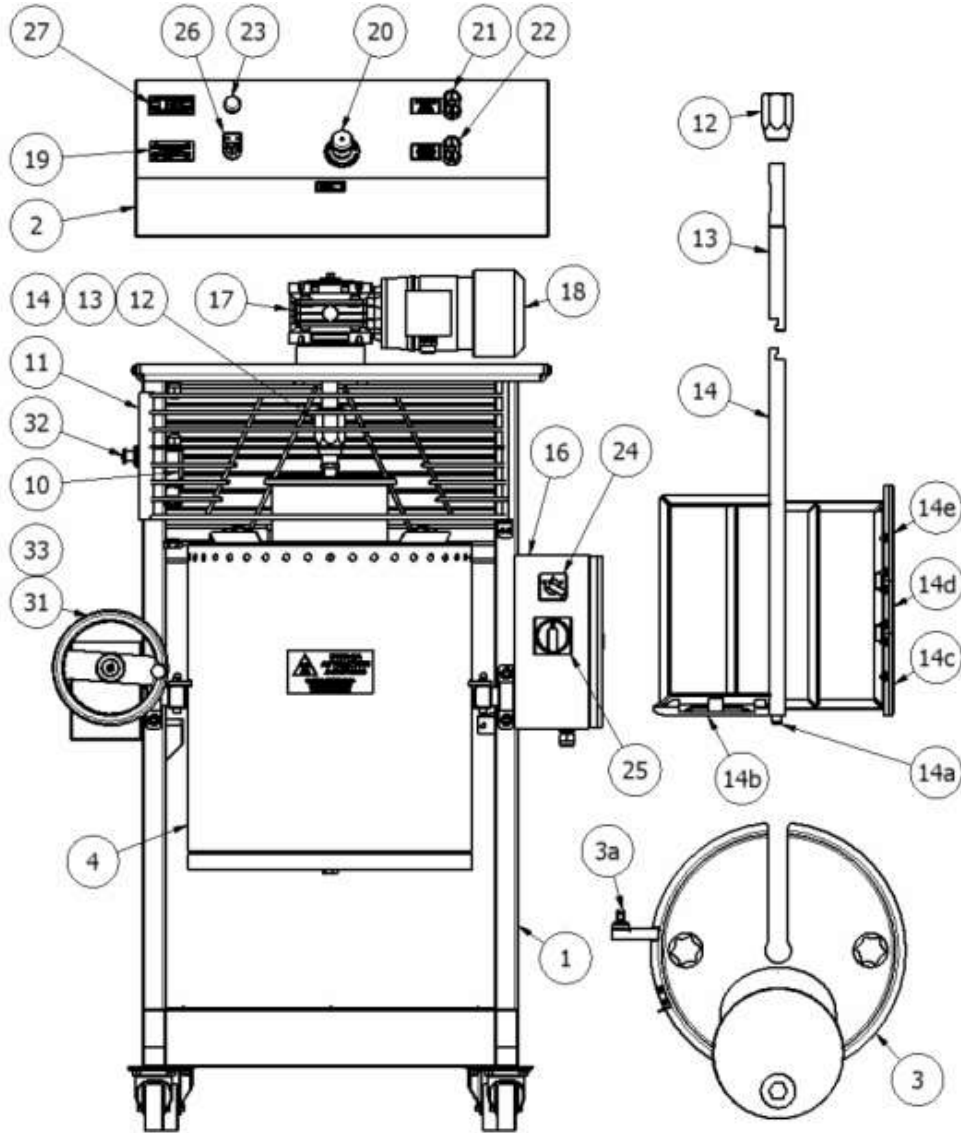

Figure 3. MC60/2E and MC80/2E design

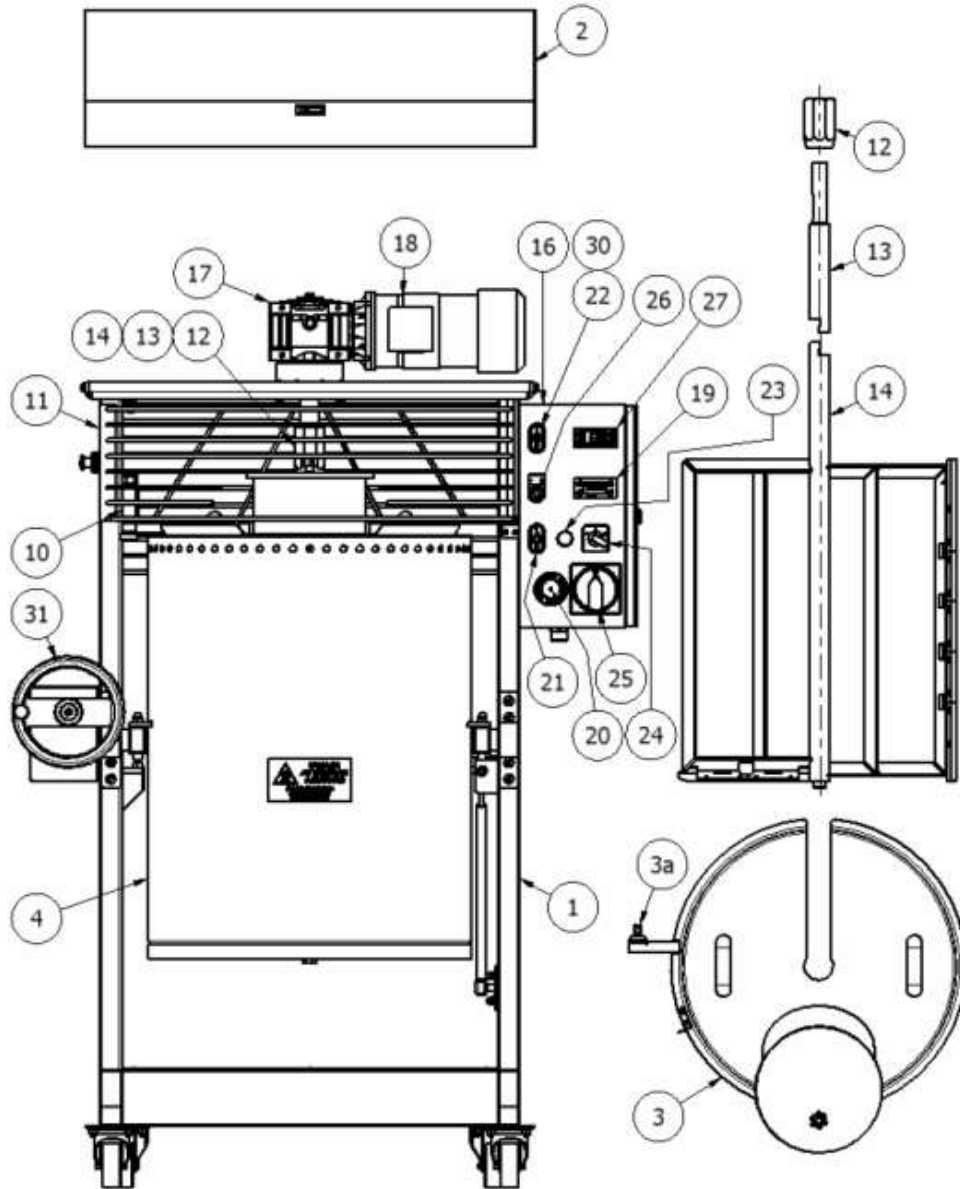

Figure 4. MC120/2E design

Drawing 5 – Replacement of heating elements		
Item	Part	Description
9	Back shield	Prevents access to heaters
9a	Heater	Heats thermal oil of the kneading trough in the oil jacket (4)
9b	Washer	
9c	Acorn nut	Used for fixing the back shield (9)
9d	Seal	
15	Threaded rod	Used for fixing the back shield with nuts (9c)

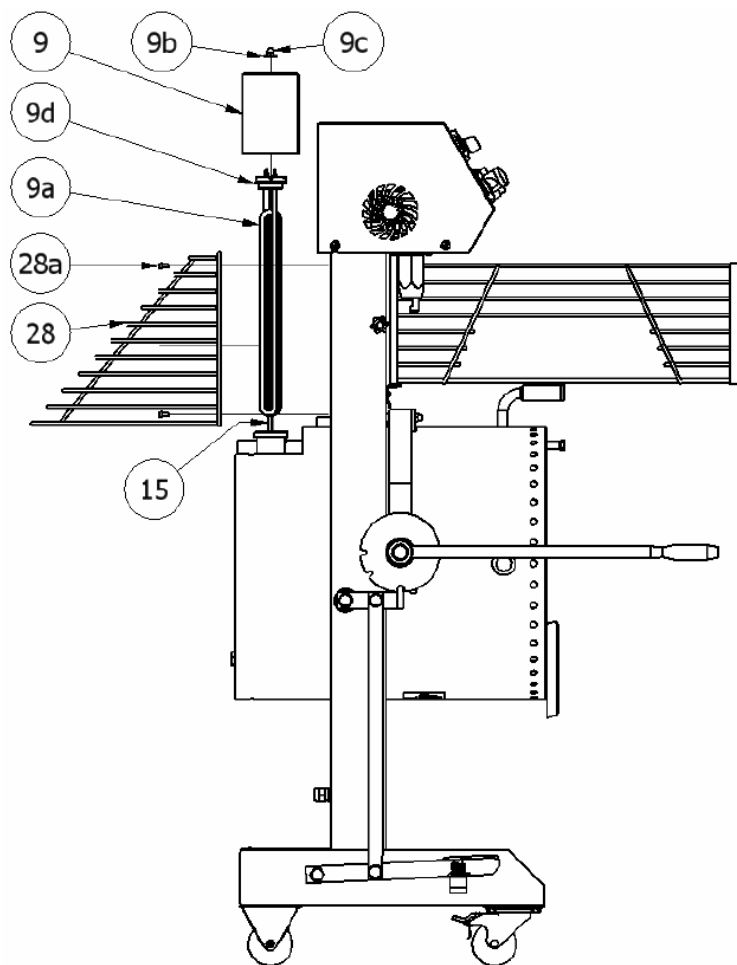

Figure 5. Replacement of heating elements