

# WIRING DIAGRAM

## SV

Fasi: 3+N

Corrente a pieno carico: 6A

Tensione di alimentazione: 400V 50Hz

Tensione di circuito di comando: 24 VDC

# WIRING DIAGRAM

## SV

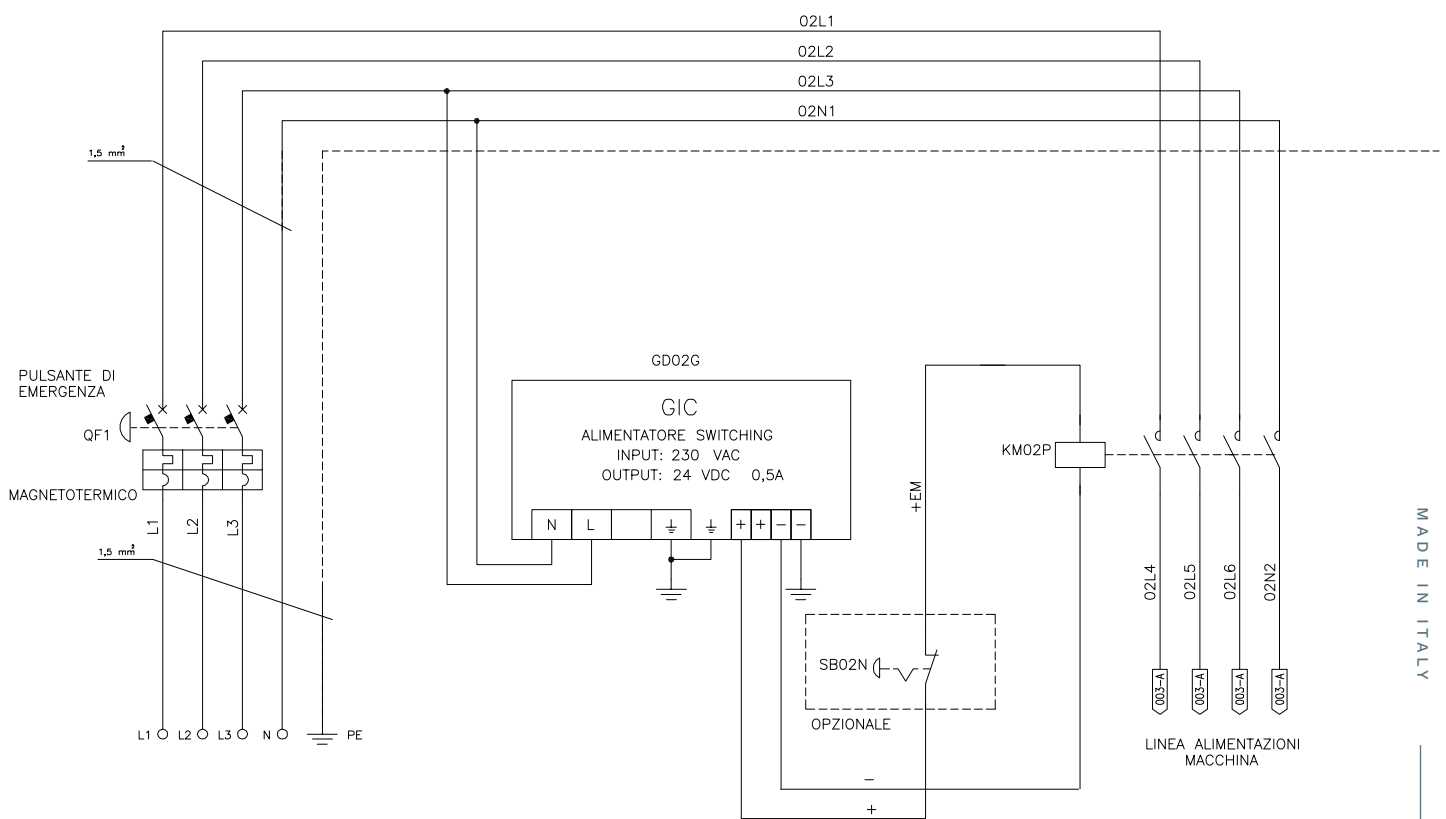

MADE IN ITALY

Linea 400v-50hz + linea alimentazioni macchina

# WIRING DIAGRAM

## SV

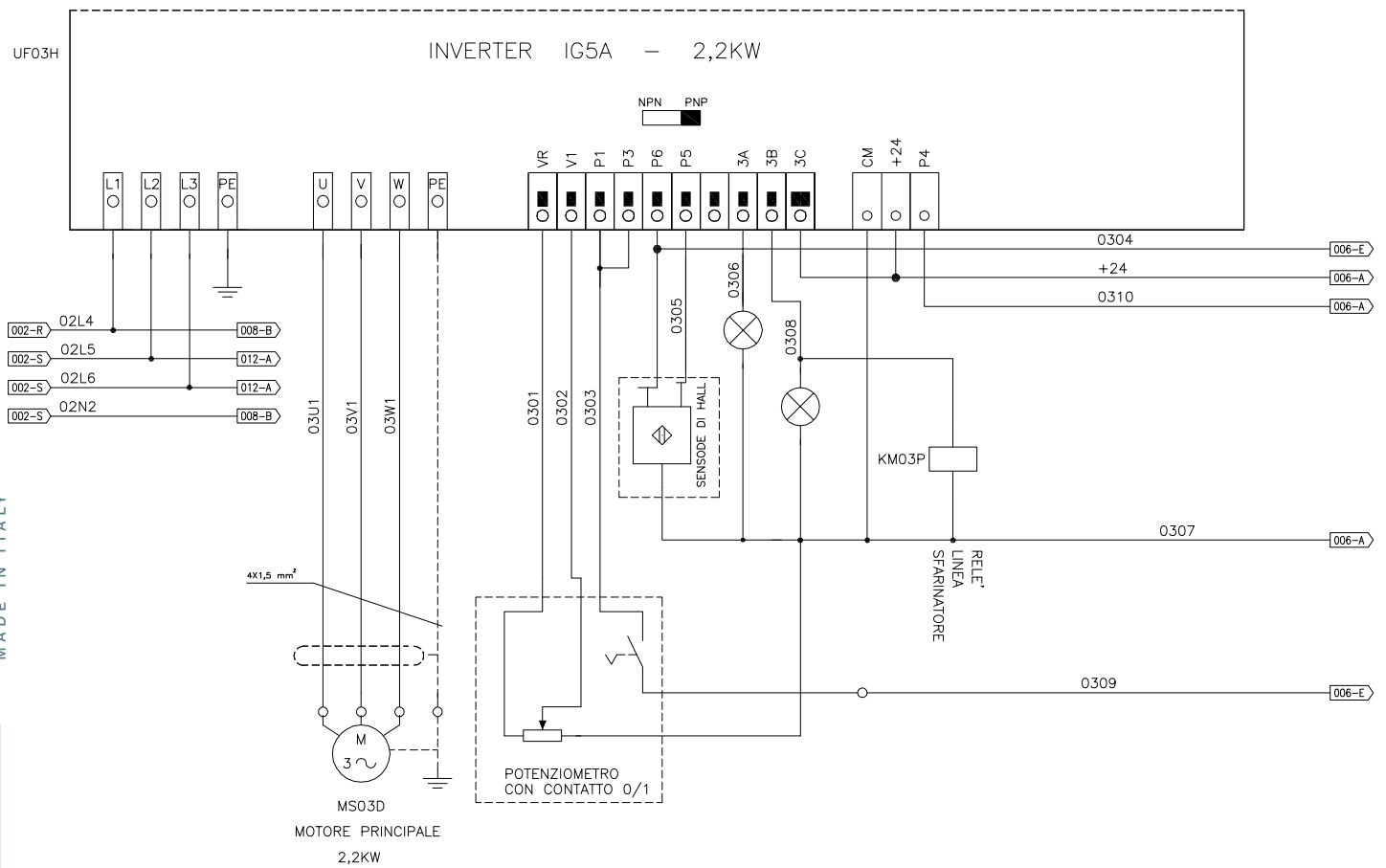

Inverter motore principale

# WIRING DIAGRAM

## SV

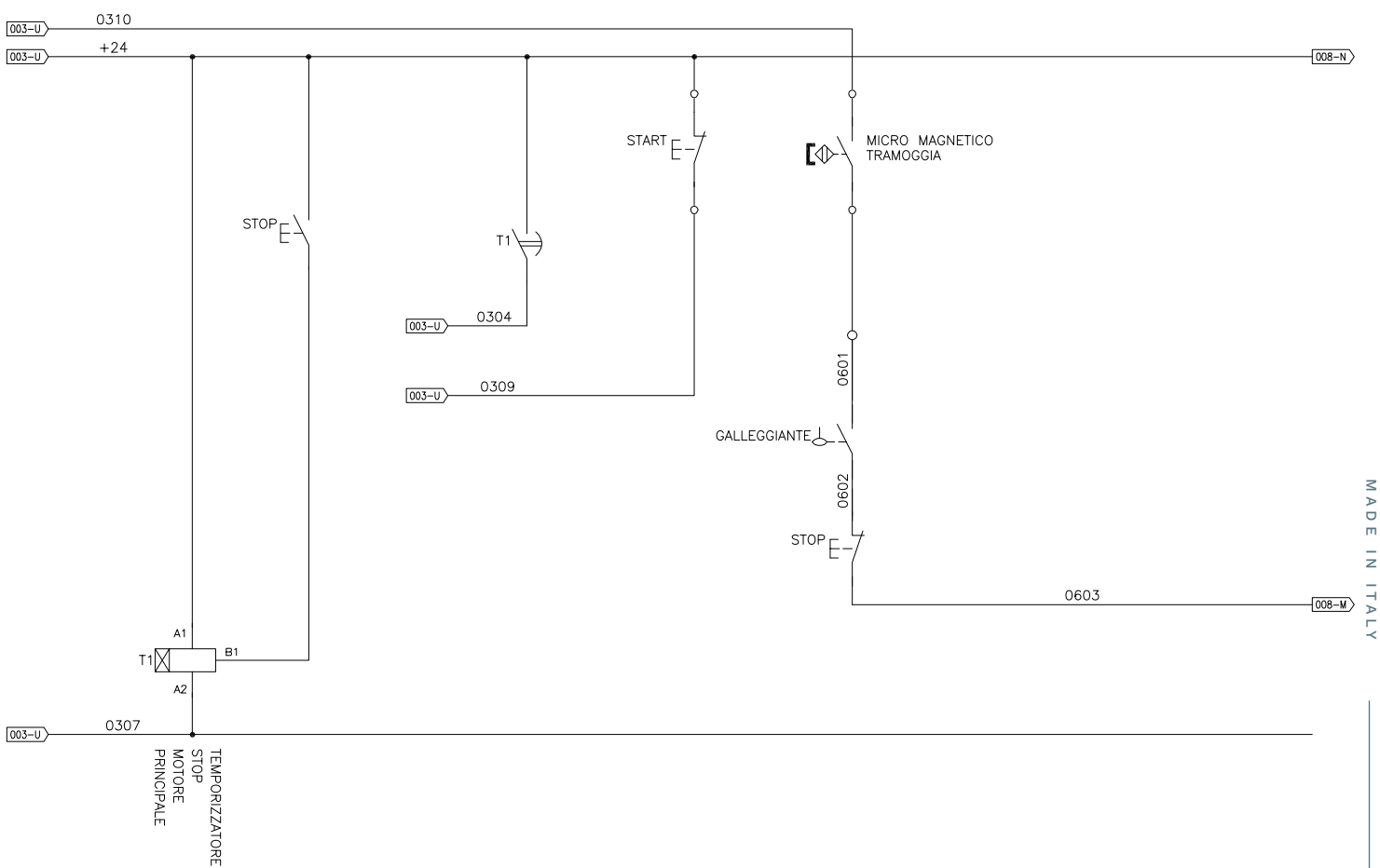

Comandi

# WIRING DIAGRAM

## SV

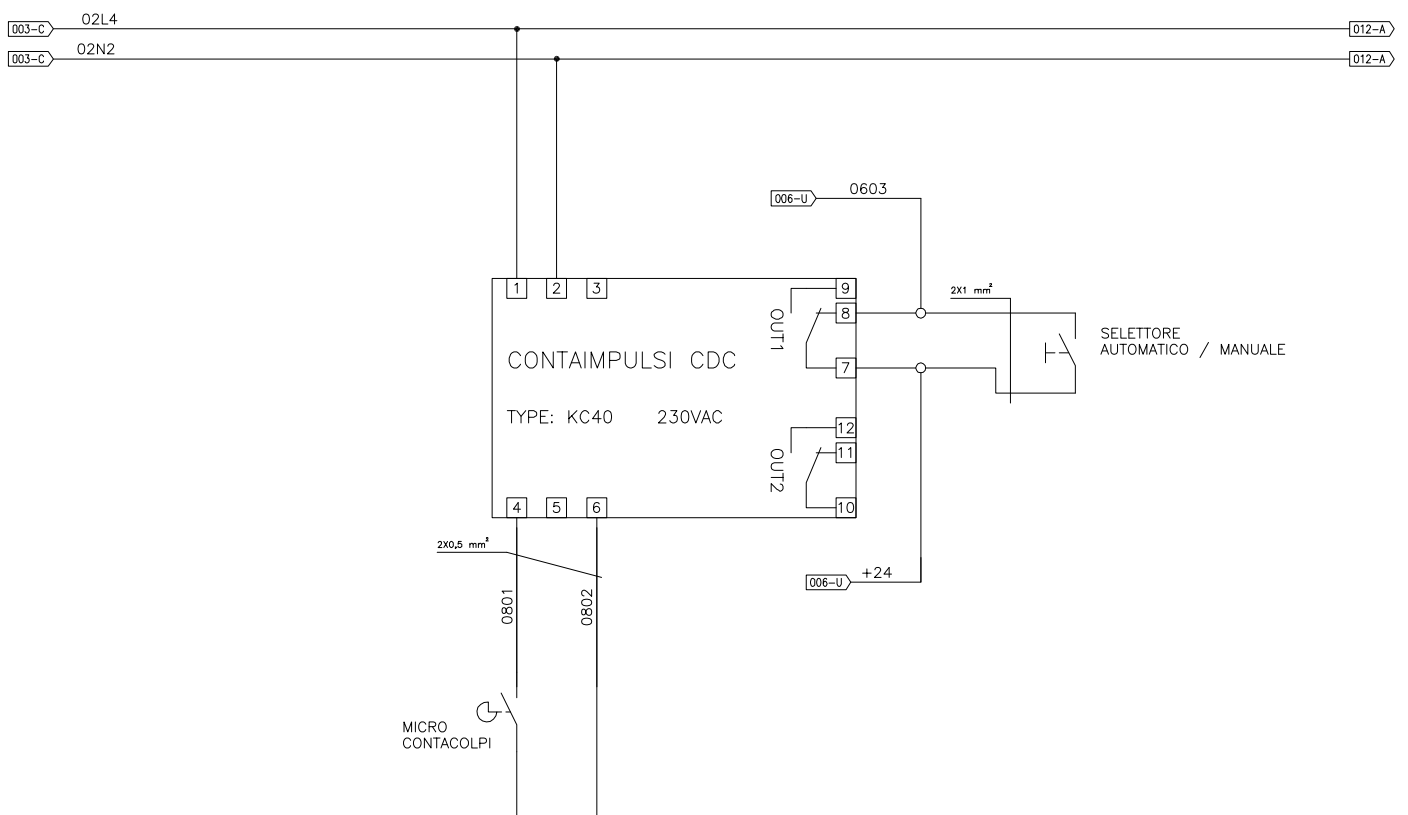

Collegamenti contacolpi

# WIRING DIAGRAM

## SV

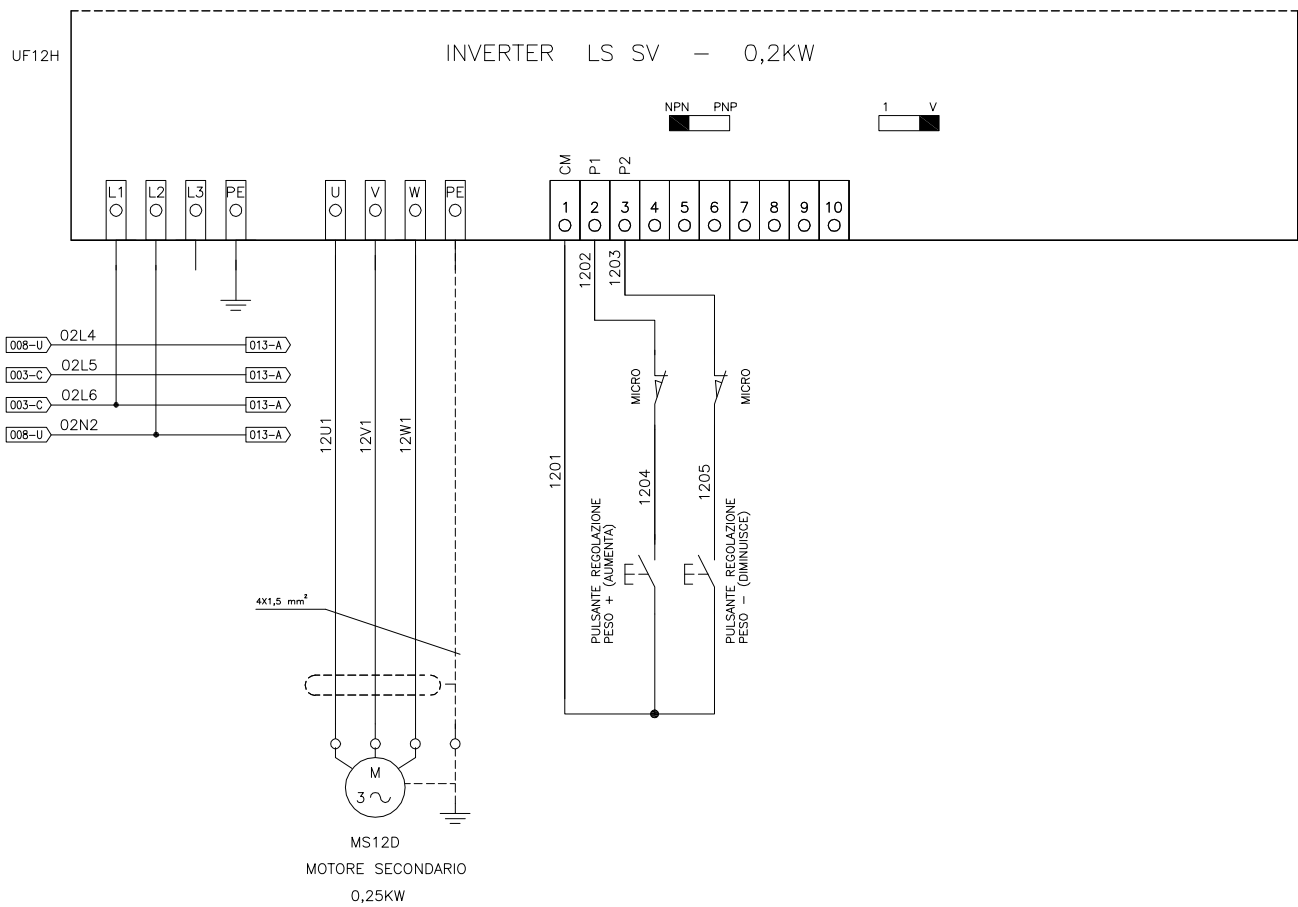

Inverter motore secondario regolazione peso

# WIRING DIAGRAM

## SV

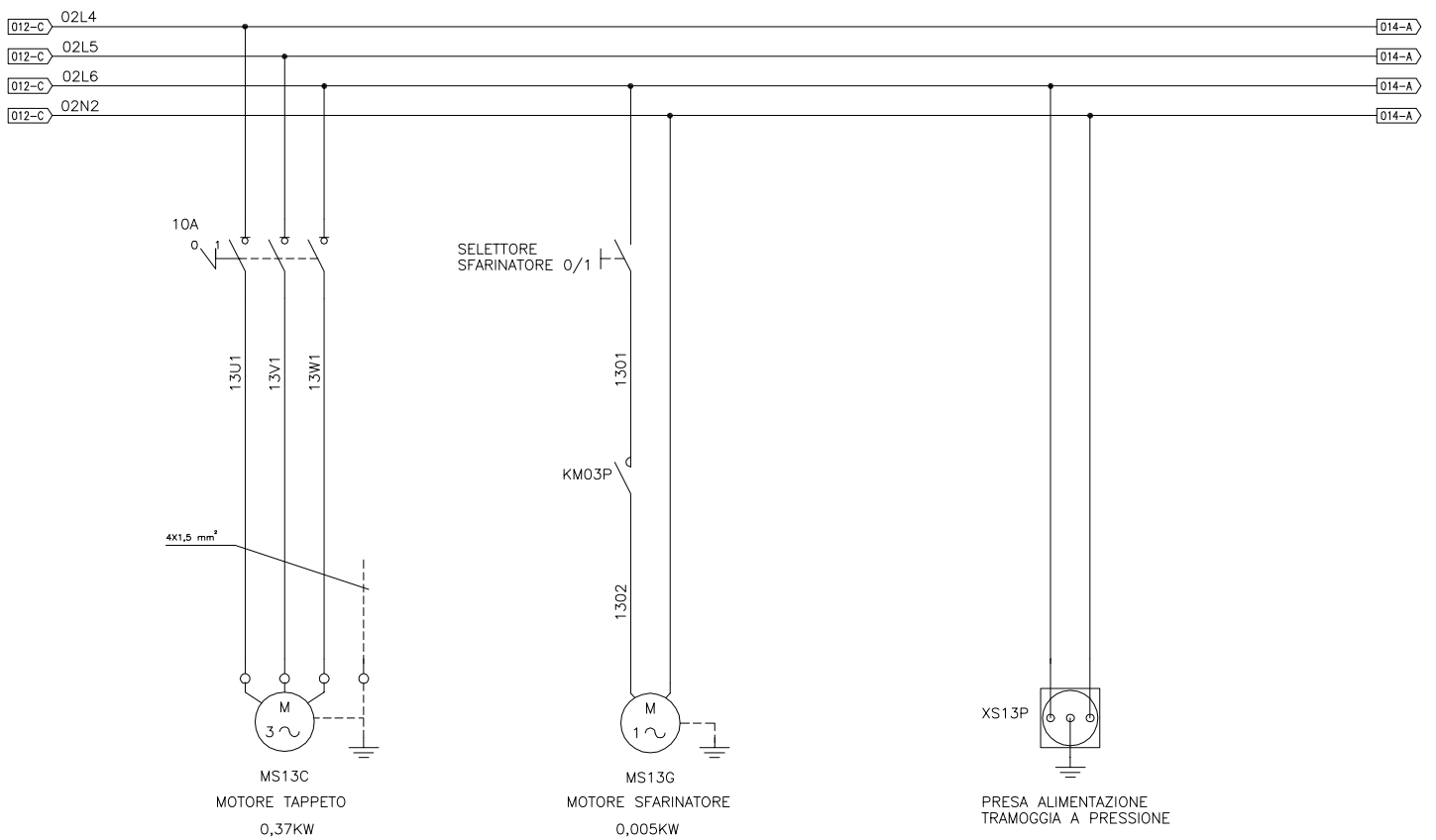

MADE IN ITALY

Collegamento motore tappeto e motore sfarinatore

# WIRING DIAGRAM

## SV

ONLY ON DEPORTED PANEL

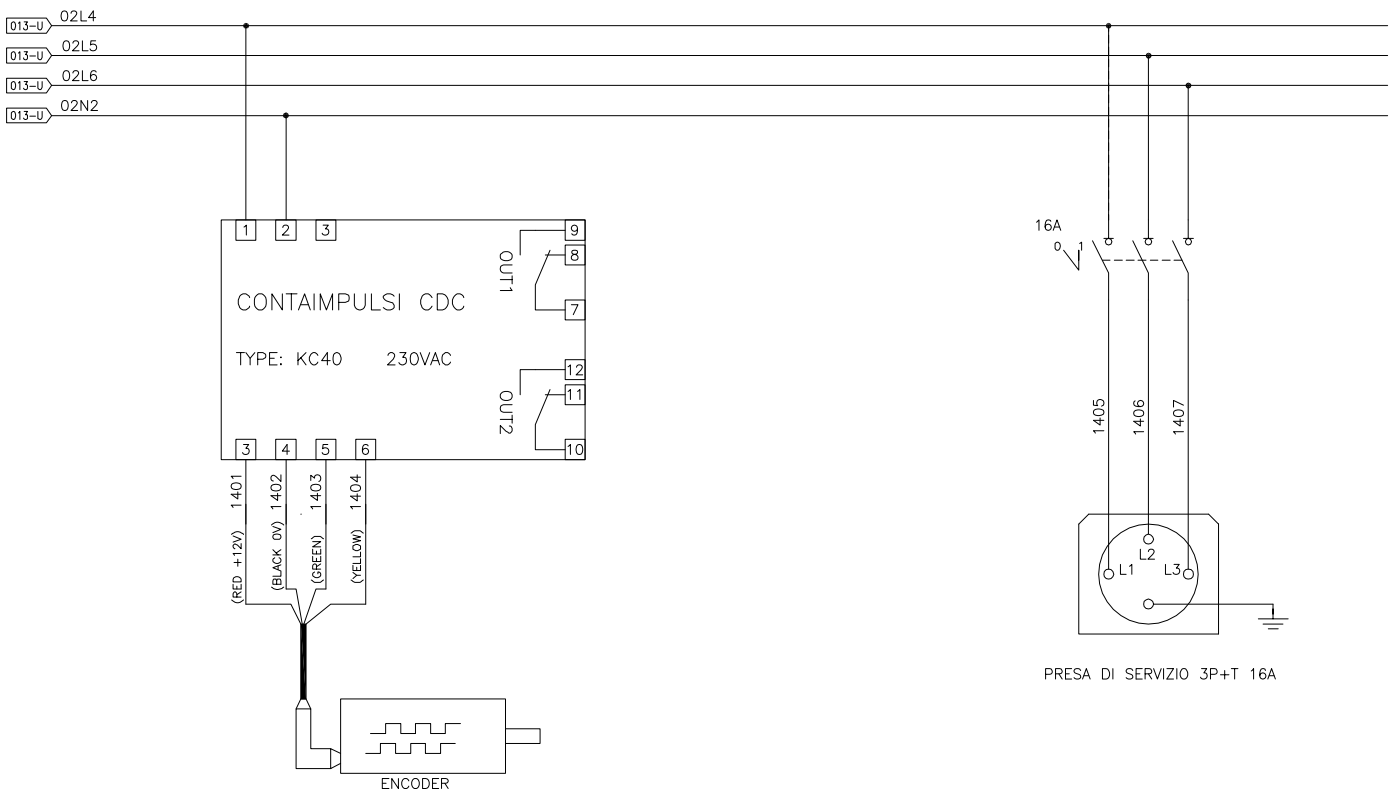

Collegamenti per encoder regolazione peso